

# STATE OF MAINE STATE HIGHWAY COMMISSION

## PLAN AND PROFILE STATE HIGHWAY "295" PORTLAND-FALMOUTH CUMBERLAND COUNTY

FEDERAL AID PROJECT NO.1-295-3(3)51 CONTRACT 2  
INTERSTATE STA.46+00 TO STA.160+00  
BASE AND DRAINAGE

TOTAL LENGTH 2.141 MILES

PLAN 1 IN. = 50 FT.  
PROFILE 1 IN. = 50 FT.  
CROSS SECTIONS 1 IN. = 5 FT.  
1 IN. = 10 FT.

### INDEX OF SHEETS

SHEET NO.	TITLE PAGE
SHEET NO. 1	TITLE PAGE
SHEET NO. 2 - 4	TYPICAL SECTIONS
SHEET NO. 5	QUANTITIES
SHEET NO. 6 - 10	STANDARD DETAILS
SHEET NO. 12 - 19	PLAN AND PROFILE
SHEET NO. 20 - 44	CROSS SECTIONS
SHEET NO. 11	SPECIAL DETAILS

### CONVENTIONAL SIGNS

STATE OR NATIONAL LINE	SURVEY LINE
COUNTY LINE	CULVERT
TOWN LINE	DROP INLET
UNFENCED PROPERTY	TROLLEY POLE
FENCE	POWER POLE
RIGHT OF WAY LINE	TEL. POLE
TRAVELED WAY	MARSH
RAILROAD	TREES
RETAINING WALL	STONE WALL

All work contemplated under this contract to be governed by and in conformity with the Standard Specifications for Highways and Bridges adopted January 1956, except as modified on the plans and in the special provisions.

TRAFFIC DATA  
1960 A.D.T. 8128  
1980 A.D.T. 11084  
D.H.V. 1663  
T. 15%  
D. 65%  
V. 60 M.P.H.

STA.46+00 INTERSTATE  
END F.A.P. NO.1-295-3(2)  
BEG. F.A.P. NO.1-295-3(3) CONTRACT 2

STA.160+00 INTERSTATE  
END F.A.P. NO.1-295-3(3) CONTRACT 2  
BEG. F.A.P. NO.1-295-3(5)

### LAYOUT PLAN

Scale: 1 inch = 500 Ft.

As built 1960

Datum: Mean Sea Level  
Boring data shown on these plans represent only the findings at the site of the borings and are not in themselves representations of actual sub-surface conditions. The Contractor is to form his own opinion and make his own interpretation of the borings. The Engineer does not warrant the finding to be accurate or complete.

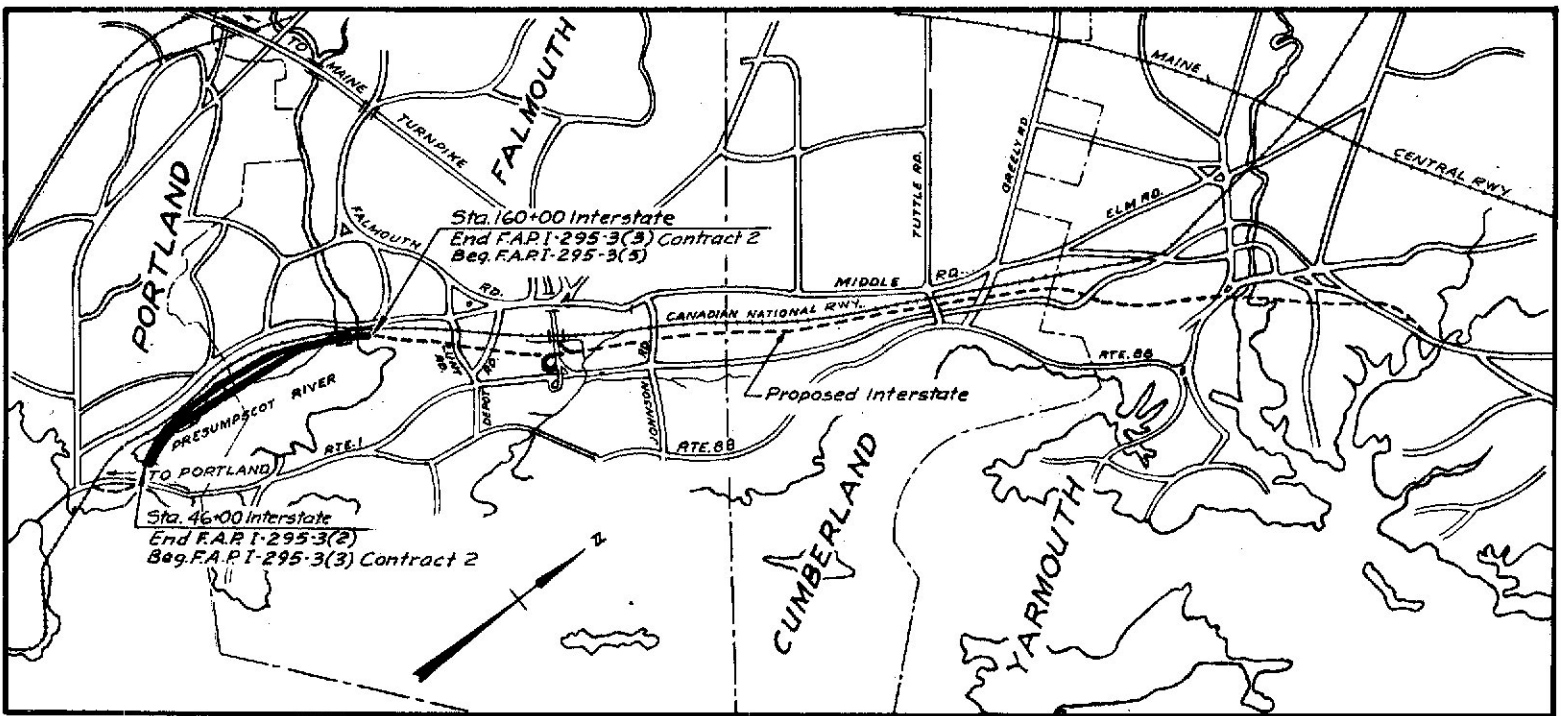

A PORTION OF CUMBERLAND COUNTY  
Approximate Scale: 1 inch = 1 mile

PREPARED BY  
**FAY, SPOFFORD & THORNDIKE, INC.**  
ENGINEERS BOSTON-PORTLAND

APPROVED:  
MAINE STATE HIGHWAY COMMISSION

*David H. Storer* CHAIRMAN  
*Robert T. Storer*  
*Leon Williams*  
*Raymond J. Storer* CHIEF ENGINEER

APPROVED:

DEPARTMENT OF COMMERCE  
BUREAU OF PUBLIC ROADS  
REGION I

DIVISION ENGINEER DATE

Qm-14

DES	J. J. S.
DR	J. J. S.
TR	J. J. S.
CHK	B. B.
APPD	H. J. W.

B. P. R.	STATE	FED. AID	SHEET	TOTAL
REG. NO.	PROJ. NO.	NO.	NO.	SHEETS
1	MAINE	1	2	44

# PORTLAND

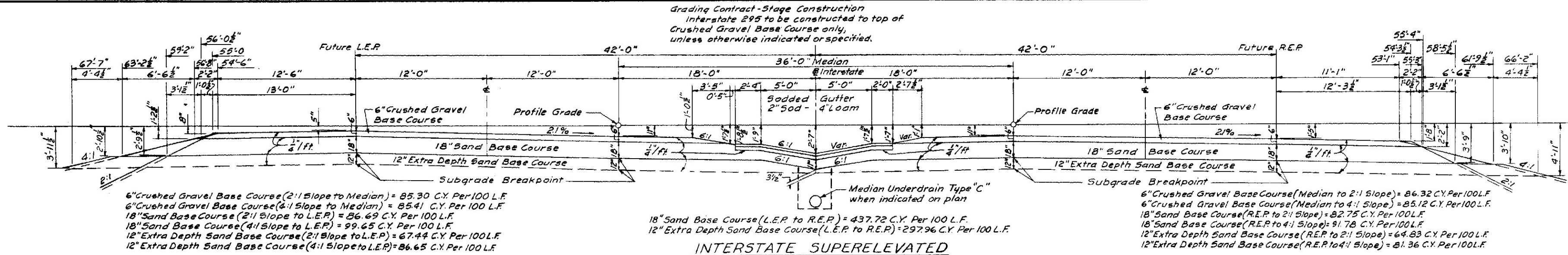

## INTERSTATE SUPERELEVATED

D = 0°-45°-00"  
Sta. 57+51.73 N.B. L.E.P. To Sta. 67+00 (E)  
Sta. 57+54.26 (E)

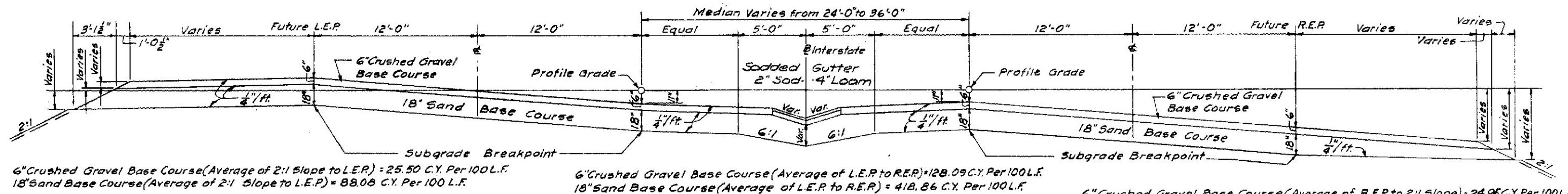

## INTERSTATE SUPERELEVATED

Sta. 52+88 N.B. L.E.P. To Sta. 57+51.73 N.B. L.E.P.  
Sta. 57+54.26 (E)

Note:  
When rate of superelevation is less than 6.25%, Sand Base Course and Crushed Gravel Base Course to the right of Future R.E.P. will slope at 1/4\"/>

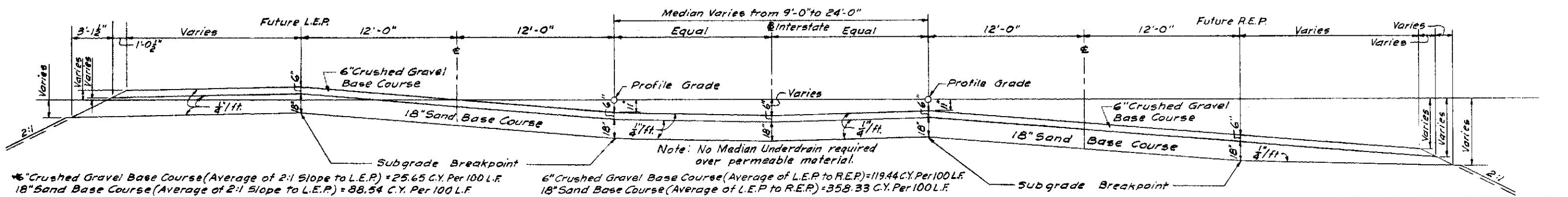

## INTERSTATE SUPERELEVATION TRANSITION

Sta. 48+01.39 To Sta. 52+88 N.B. L.E.P.

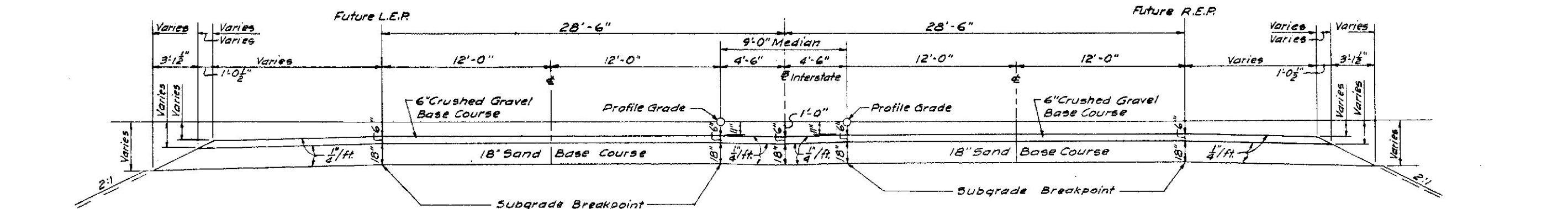

## INTERSTATE SUPERELEVATION TRANSITION

Sta. 46+00 To Sta. 48+01.39 (E)

STATE HIGHWAY COMMISSION AUGUSTA, MAINE	
PORTLAND-YARMOUTH INTERSTATE	
TYPICAL CROSS SECTIONS INTERSTATE PART I	
SHEET NO. 2 OF 44	SCALE: HORI: 1"=5'-0" VERT: 1"=5'-0"

FAY, SPOFFORD & THORNDIKE, INC.  
ENGINEERS BOSTON, MASS.

Qm-14  
534

DES.	F.B.
DR.	F.B.
TR.	J.C.P.
CHK.	H.J.W.



B. P. R.	STATE	FED. AID	SHEET	TOTAL
REG. NO.		PROJ. NO.	NO.	SHEETS
1	MAINE	2-593-3(9)	3	44

# PORTLAND - FALMOUTH

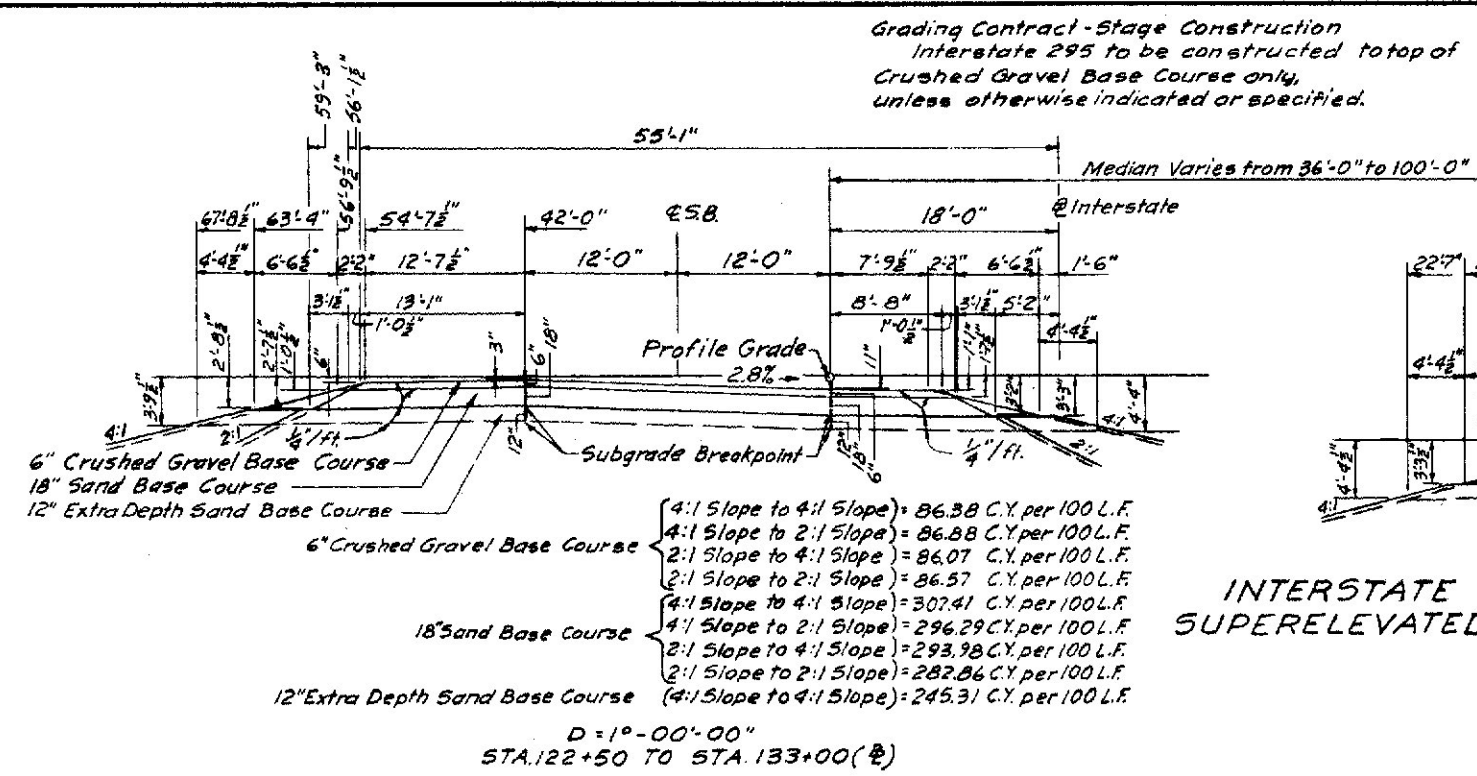

## INTERSTATE SUPERELEVATED

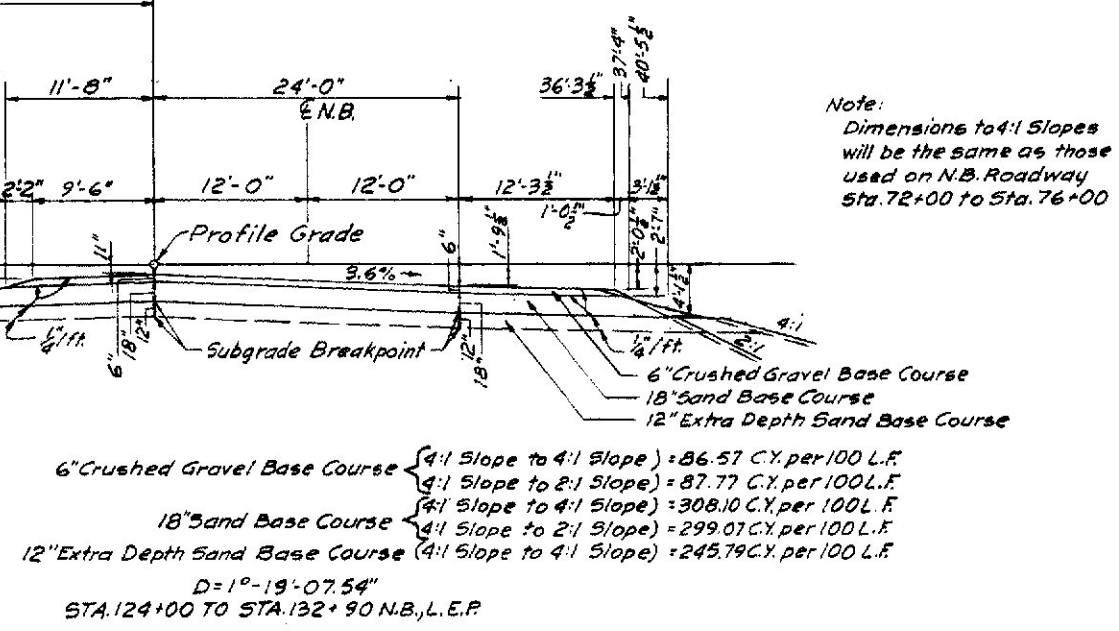

Note:  
Dimensions to 4:1 Slopes  
will be the same as those  
used on N.B. Roadway  
Sta. 72+00 to Sta. 76+00

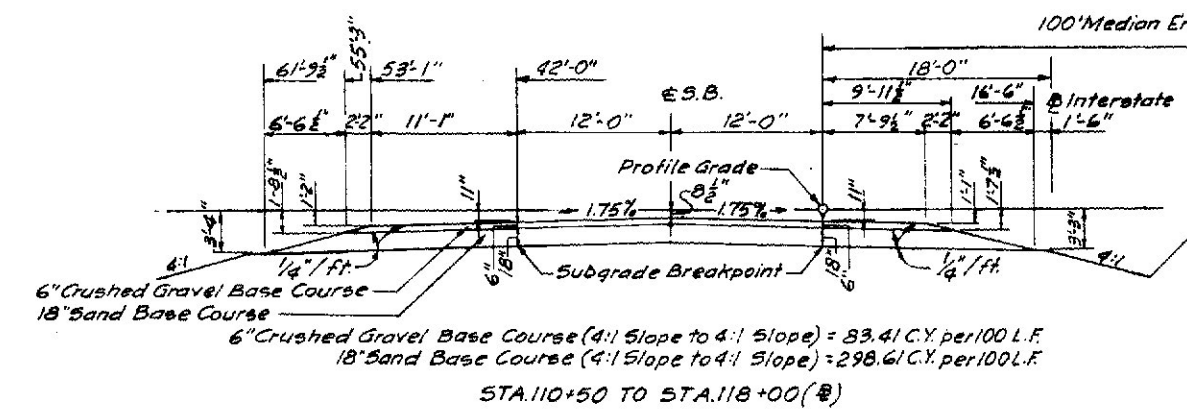

## INTERSTATE NORMAL

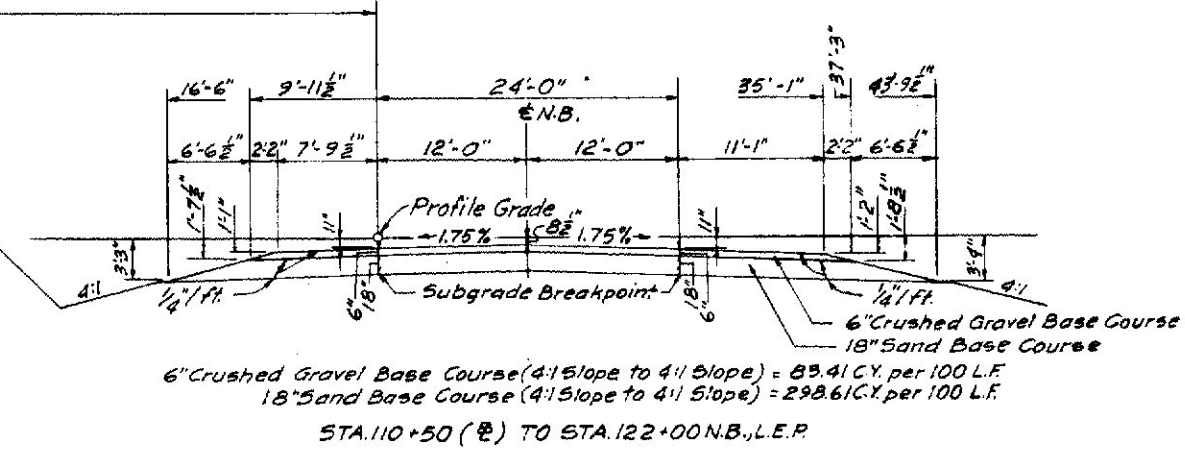

Note:  
Dimensions to 4:1 Slopes  
will be the same as  
those used on N.B. Roadway  
Sta. 78+00 to Sta. 110+50

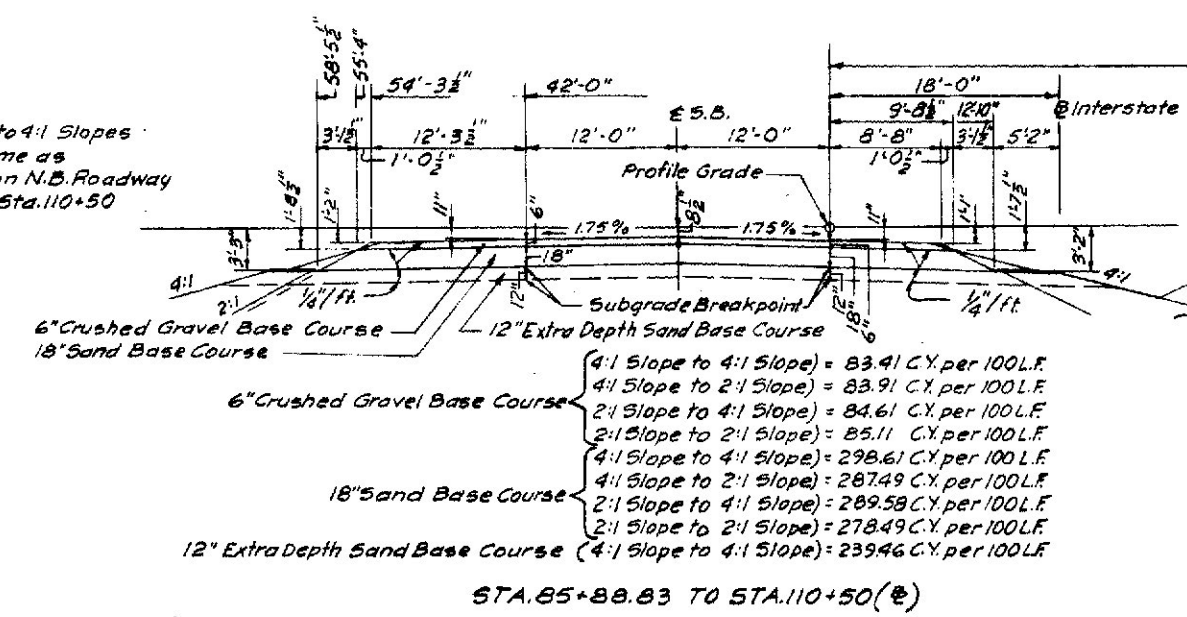

## INTERSTATE NORMAL

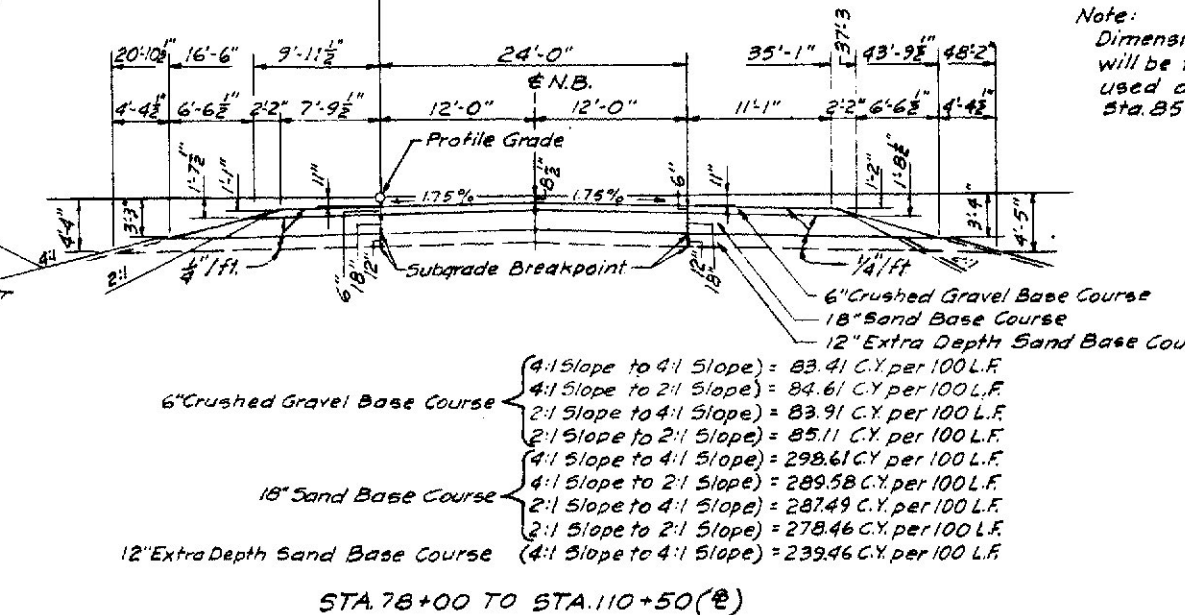

Note:  
Dimensions to 2:1 Slopes  
will be the same as those  
used on S.B. Roadway  
Sta. 85+88.83 To Sta. 110+50

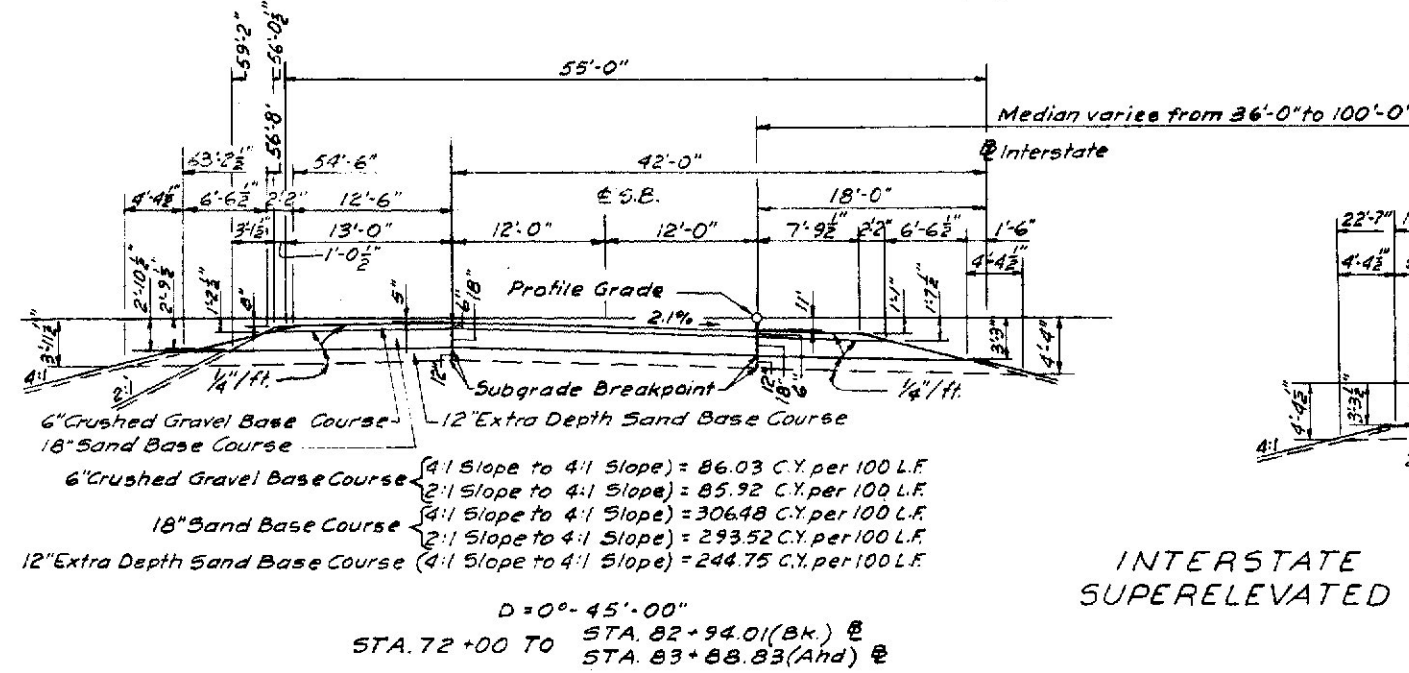

## INTERSTATE SUPERELEVATED

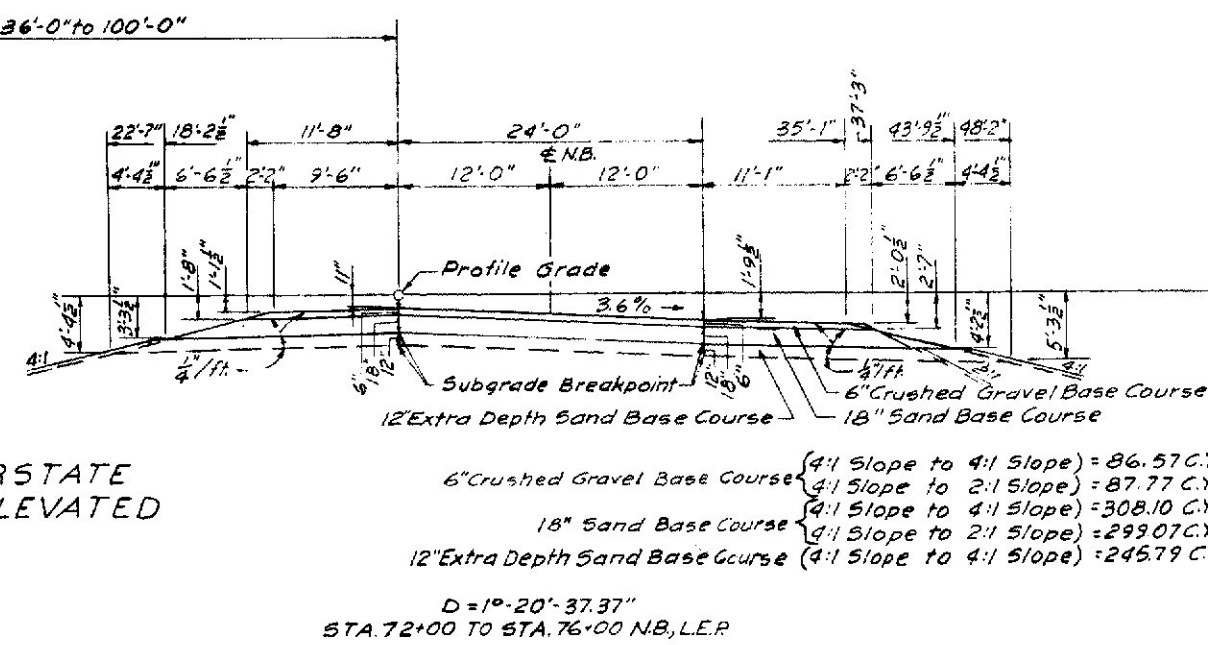

Note:  
Dimensions to 2:1 Slopes  
will be the same as those  
used on N.B. Roadway  
Sta. 124+00 to Sta. 132+90

STATE HIGHWAY COMMISSION AUGUSTA, MAINE	
PORTLAND-YARMOUTH INTERSTATE	
TYPICAL CROSS SECTIONS INTERSTATE PART II	
SHEET NO. 3 OF 44	SCALE: HOR. 1"=40'-0" VERT. 1"=40'-0"
FAY, SPOFFORD & THORNDIKE, INC. ENGINEERS BOSTON, MASS.	
Qm-14 535	

DES.	J.J.S.F.B.
DR.	F.B.J.J.S.
CHK.	J.C.P.
APPD.	H.J.W.

B. P. R.	STATE	FED. AID	SHEET	TOTAL
REG. NO.		PROJ. NO.	NO.	SHEETS
1	MAINE	2-197-3(1)	4	44

FALMOUTH

Grading Contract-Stage Construction  
Interstate 295 to be constructed to top of  
Crushed Gravel Base Course only,  
unless otherwise indicated or specified.

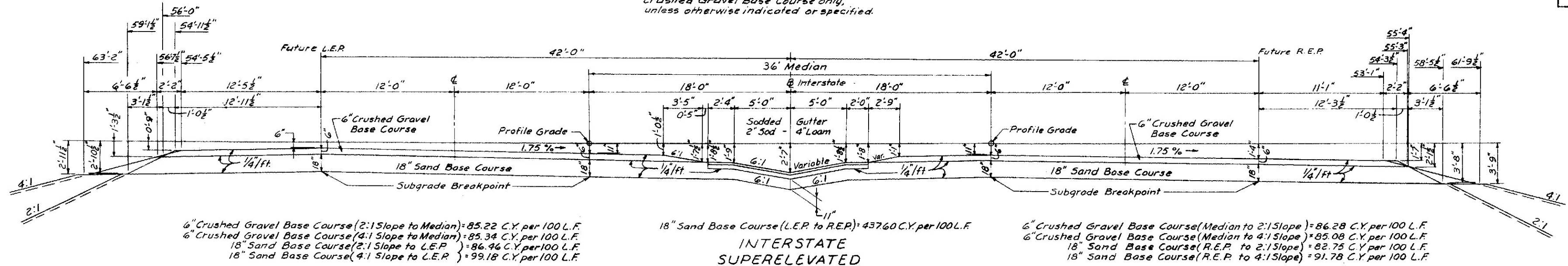

INTERSTATE  
SUPERELEVATED  
D = 0° 18' 00"  
STA. 154+30 TO STA. 160+00 (B)

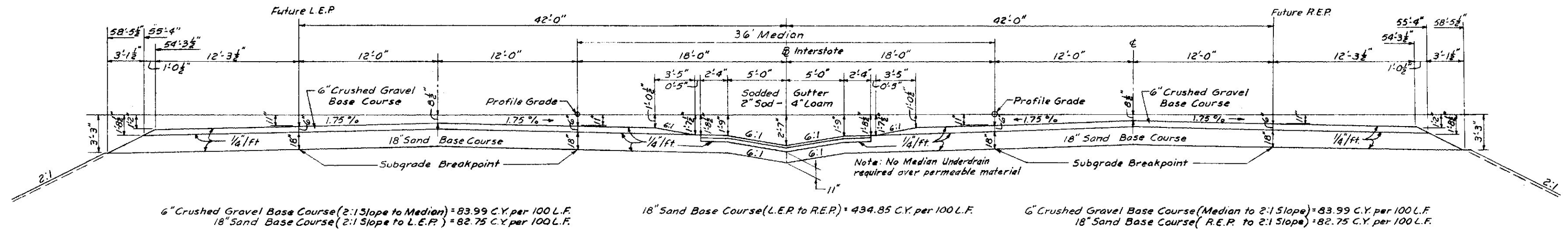

INTERSTATE  
NORMAL  
STA. 148+00 TO STA. 152+30 (B)

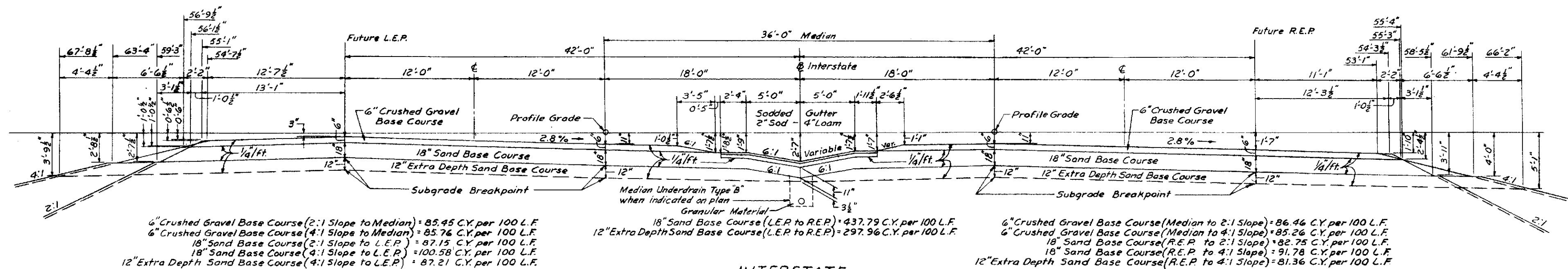

INTERSTATE  
SUPERELEVATED  
D = 1° 00' 00"  
STA. 136+87.90 NB, L.E.P. TO STA. 146+00 (B)  
= STA. 137+00 (B)

STATE HIGHWAY COMMISSION AUGUSTA, MAINE	
PORTLAND-YARMOUTH INTERSTATE	
TYPICAL CROSS SECTIONS INTERSTATE PART III	
SHEET NO. 4 OF 44	SCALE: HORIZ. = 5'-0" VERT. = 5'-0"
FAY, SPOFFORD & THORNDIKE, INC. ENGINEERS	BOSTON, MASS.

DES.	J.M.M.
DR.	J.M.M.
CHK.	J.C.P.
APPD.	H.J.W.



PORTLAND-FALMOUTH

FINAL

DRAINAGE												
STATION	SIZE	ACCOMP.	R.C.P.	ACCOMP.	METHOD	PIPE CONN.	CONCRETE			ENDWALLS		REMARKS
		LEFT	L.F.	RIGHT			PORTLAND CEMENT	PORTLAND CEMENT	PORTLAND CEMENT	REINFORCING	DEL'D PLACING	
	IN.	L.F.	L.F.	L.F.		EA.	C.Y.	Bbl.	EA.	EA.	EA.	
INTERSTATE												
49+50	15		36	14	A	/						/
52+00	15		44	13	A	/						/
54+50	15		38	20	A	/						/
59+00	15		48	16	A	/						/
68+00												/
131+00	15		58	54	A	/						/
139+30	24		50	14	A	/						/
143+00	15		50	14	A	/						/
145+75	15		52	14	A	/						/
152+50	15		50	14	A	/						/
157+00	15	34	48		A	/			2	4		/

PRELIMINARY

For as built details see plan and profile sheets.

SAND BASE COURSE		
STA. TO STA.	QUANTITY (CY)	REMARKS
INTERSTATE		
47+00 TO 149+00	59856	18" Depth
152+00 TO 160+90	5202	18" Depth
EXTRA DEPTH		
63+75 TO 65+75	900	12" Depth
76+25 TO 86+25	2874	12" Depth
95+50 TO 97+25	420	12" Depth
99+75 TO 103+25	1437	12" Depth
104+25 TO 109+75	2275	12" Depth
122+75 TO 132+25	3436	18" Depth
133+75 TO 142+25	3529	12" Depth
160+00 TO 161+00	443	12" Depth
UNLISTED LOCATIONS	2500	

FINAL

ESTIMATED QUANTITIES				
ITEM	DESCRIPTION	FINAL	PRELIMINARY	UNIT
		QUANTITY	QUANTITY	
203-9	Earth Excavation	0	100	CY
204-10	Structural Earth Excavation-Drainage	2,112	1,600	CY
204-11	Structural Rock Excavation-Drainage	13.2	100	CY
301-7	Sand Base Course - In Place Measurement	79,168	83,000	CY
302-9	Crushed Gravel Base Course - In Place Measurement	18,160	19,000	CY
308-5	Overhaul (In Place Measure)	585438	478,000	Y.M.
309-5	Stripping Pits	0	16,000	CY
602-11	15" Asphalt Coated Corrugated Metal Pipe	189	150	L.F.
602-14	24" Asphalt Coated Corrugated Metal Pipe	15	13	L.F.
602-23	15" x 6' Asphalt Coated Corrugated Metal Bends	0	2	each
602-24	15" x 2' Asphalt Coated Corrugated Metal Connecting Bands	0	4	each
603-11	15" Reinforced Concrete Pipe	444	500	L.F.
603-13	24" Reinforced Concrete Pipe	58	60	L.F.
605-25	Catch Basins - Type "F"	9.75	2	each
605-28	Catch Basins - Type "T"	1,125	2	each
606-10	Underdrain - Type "B"	3,693	2,700	L.F.
606-12	15" Underdrain - Type "C"	396	440	L.F.
606-16	Underdrain Outlets	126	300	L.F.
908-9	Loam Borrow	750	750	CY
909-7	Sodding	6448	6,700	S.Y.
916-6	Underdrain Outlet Markers	0	5	each
	Gravel for Foundations	8	0	CY

FINAL

UNDERDRAIN					
STA. TO STA.	SIDE	UNDERDRAIN			REMARKS
		TYPE "B" (6")	TYPE "C" (15")	OUTLET MARKERS	
		L.F.	L.F.	EA.	
INTERSTATE					
64+08 To 67+98			396		
68+02 To 73+50		548			
126+57 To 130+98		441			
107+50 To 109+50		200			
131+04 To 135+44		440			
135+58 To 139+28		370			
139+36 To 142+98		362			
157+02 To 160+00		298			
143+05 To 145+73		268			
145+77 To 149+00		323			
152+52 To 156+95		443			

PRELIMINARY

SODDING AND LOAM		
STA. TO STA.	SIDE	REMARKS
INTERSTATE		
52+88 To 71+90	Median	2" Sod over 4" Loam
135+00 To 160+00	Median	2" Sod over 4" Loam

PRELIMINARY

For as built details see plan and profile sheets.

CRUSHED GRAVEL BASE COURSE		
STA. TO STA.	QUANTITY (CY)	REMARKS
INTERSTATE		
47+00 TO 149+00	17,278	6" Depth
152+00 TO 160+90	1,478	6" Depth



PLAN  
DATE 9/17/58  
BY R.S.S.  
NOTE BOOK PLOTTED  
CHECKED BY R.T. OF MAY CHECKED  
NO.

PROFILE  
DATE 9/17/58  
BY R.S.S.  
NOTE B.V. GRADES CHECKED  
B. M. NOTED  
STRUCTURE NOTATIONS CH'D.  
NO.

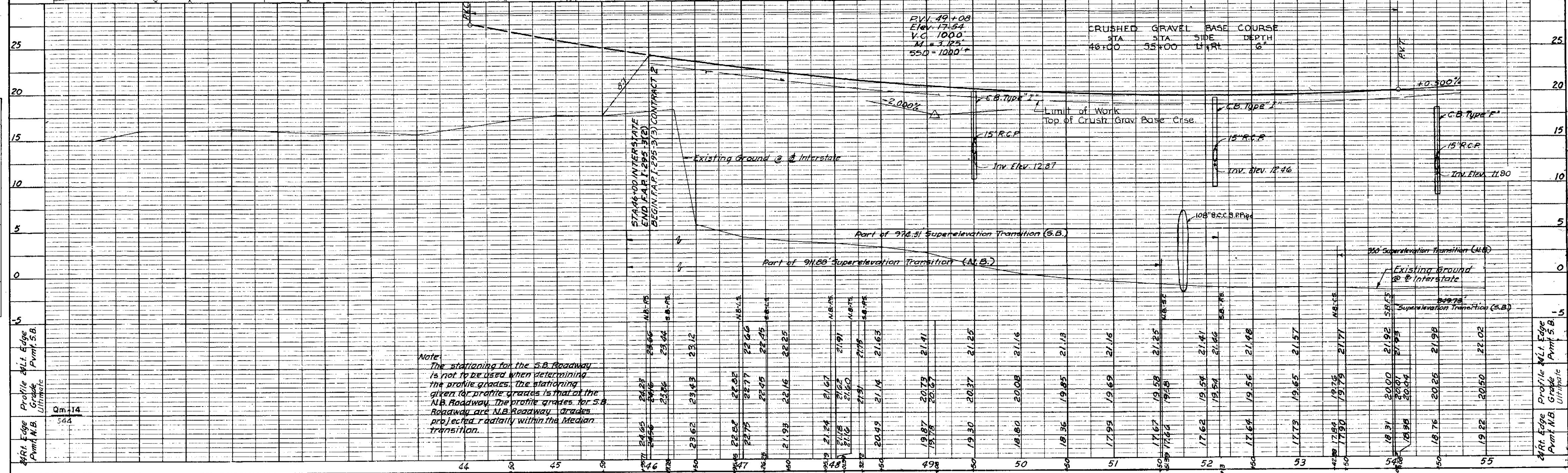
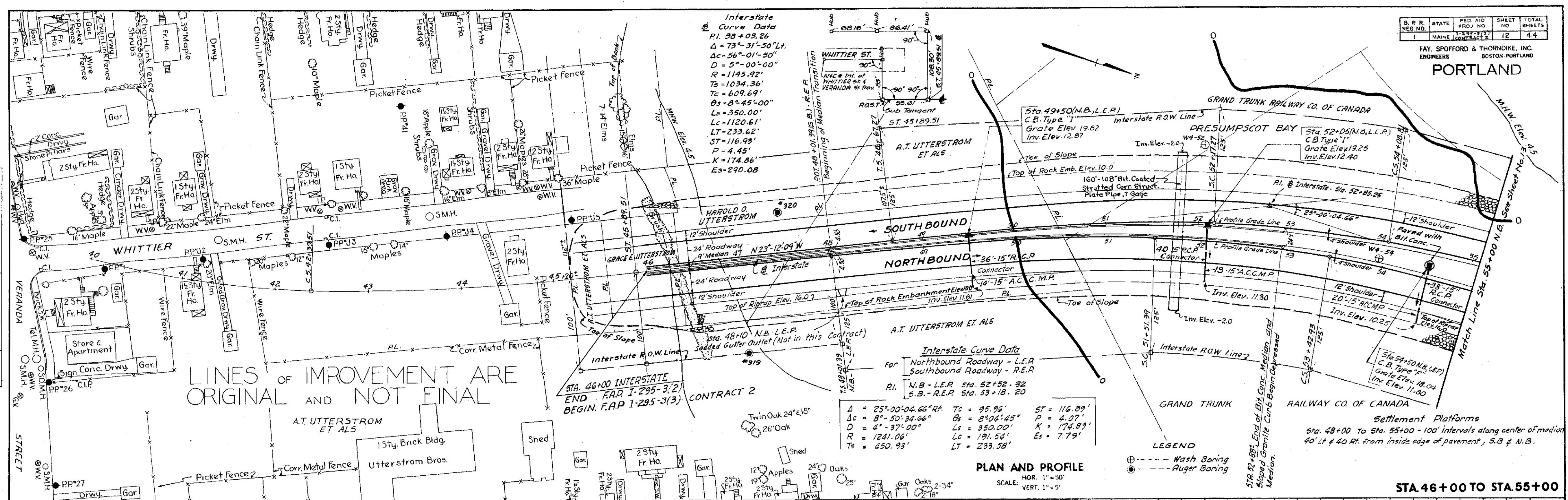







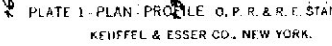
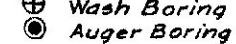
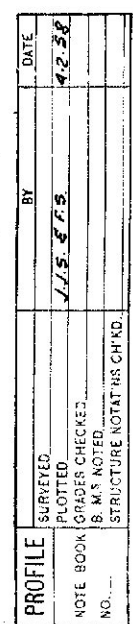







PLAN	SURVEYED	BY	DATE
	NOTE BOOK GRADES CHECKED	J.L.B. & J.S.	5-2-58
	NO. 1		

PROFILE	SURVEYED	BY	DATE
	NOTE BOOK GRADES CHECKED	J.S.	5-2-58
	NO. 1		

S.P.R.	STATE	FED. AID	SHEET	TOTAL
1	MAINE	5-297-373	16	44

FAY, SPOFFORD & THORNDIKE, INC.  
ENGINEERS  
BOSTON-PORTLAND

FALMOUTH

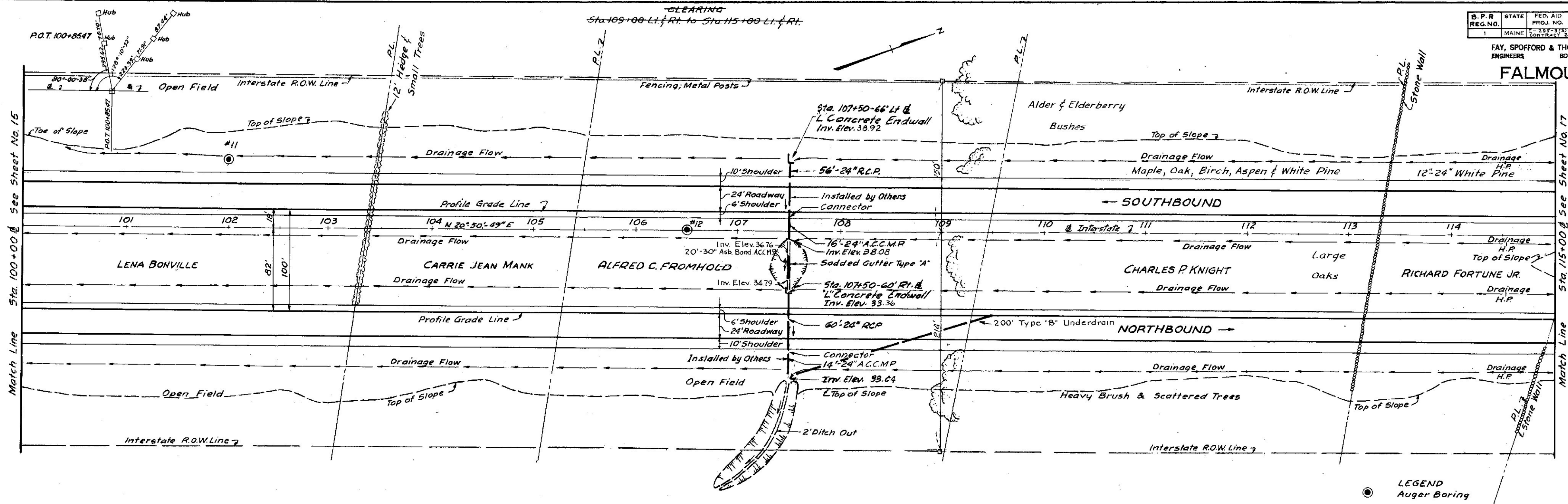

PLAN AND PROFILE

SCALE: HOR. 1" = 50'  
VERT. 1" = 5'

STA 100+00 TO STA 115+00

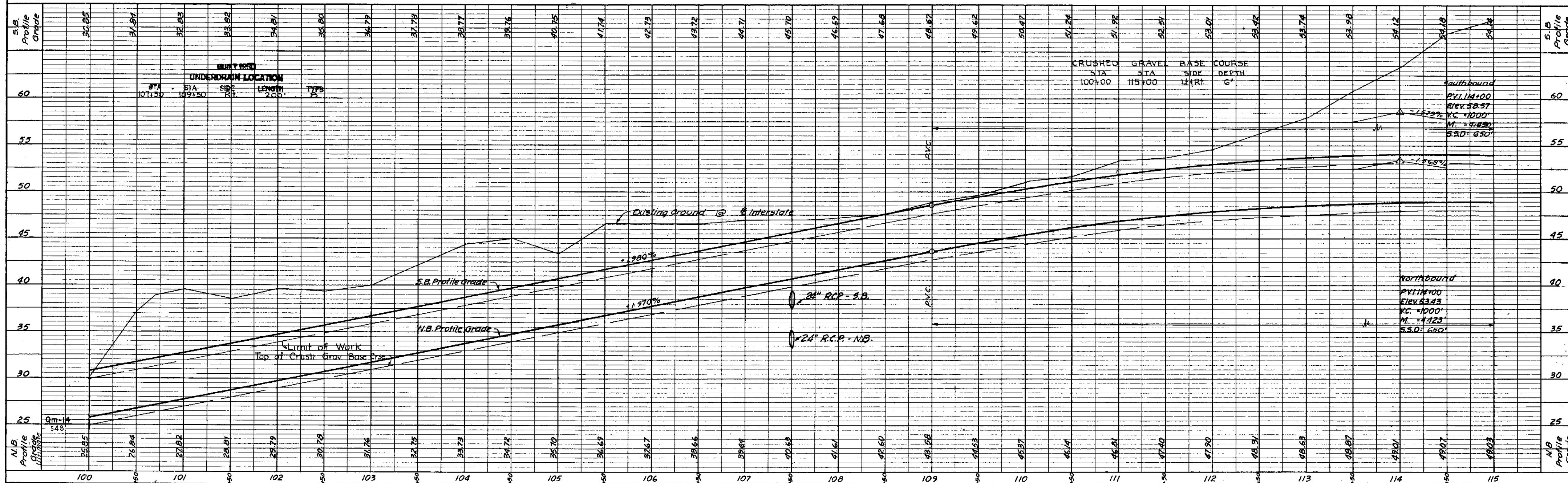



PLAN	SURVEYED	DATE	BY
	PLOTTED	4.3.52	J.S.
	CHECKED		
	RT. OF WAY CHECKED		
	NO.		

PROFILE	SURVEYED	DATE	BY
	PLOTTED	5.5.52	F.S.
	CHECKED		
	STRUCTURE NOTATIONS CHD.		
	NO.		

B. P. R.	STATE	FED. AID	SHEET	TOTAL
1	MAINE	1387-701	17	44

FAY, SPOFFORD & THORNDIKE, INC.  
ENGINEERS BOSTON-PORTLAND

FALMOUTH

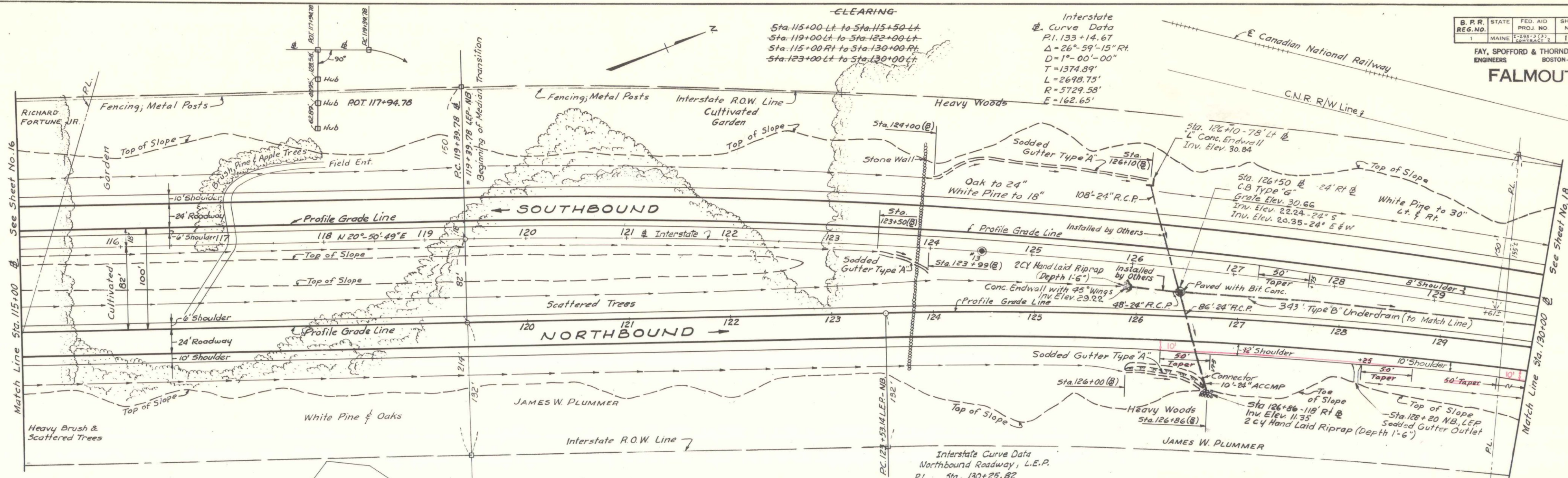

# PLAN AND PROFILE

SCALE: HOR. 1" = 50'  
VERT. 1" = 5'

## LEGEND

Auger Boring

STA. 115+00 TO STA. 130+00

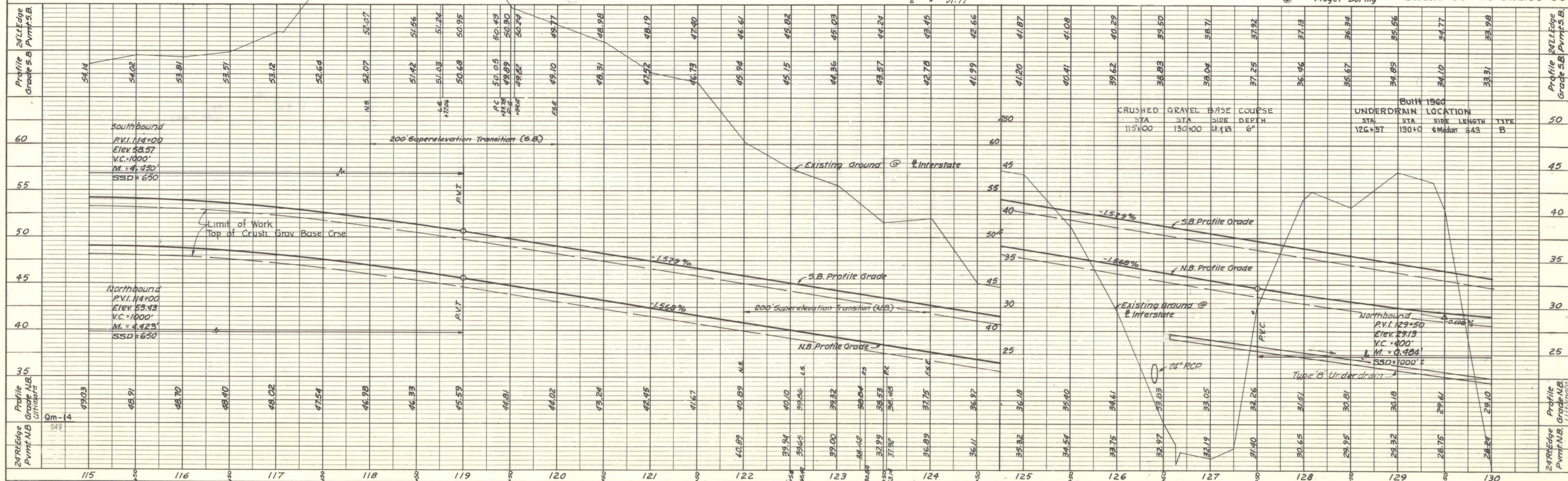



PLAN	DATE	BY
SURVEYED	7-14-58	R. S. S.
PLOTTED		
NOTE BOOK		
NO.		

PROFILE	DATE	BY
SURVEYED	7-14-58	R. S. S.
PLOTTED		
NOTE BOOK		
NO.		

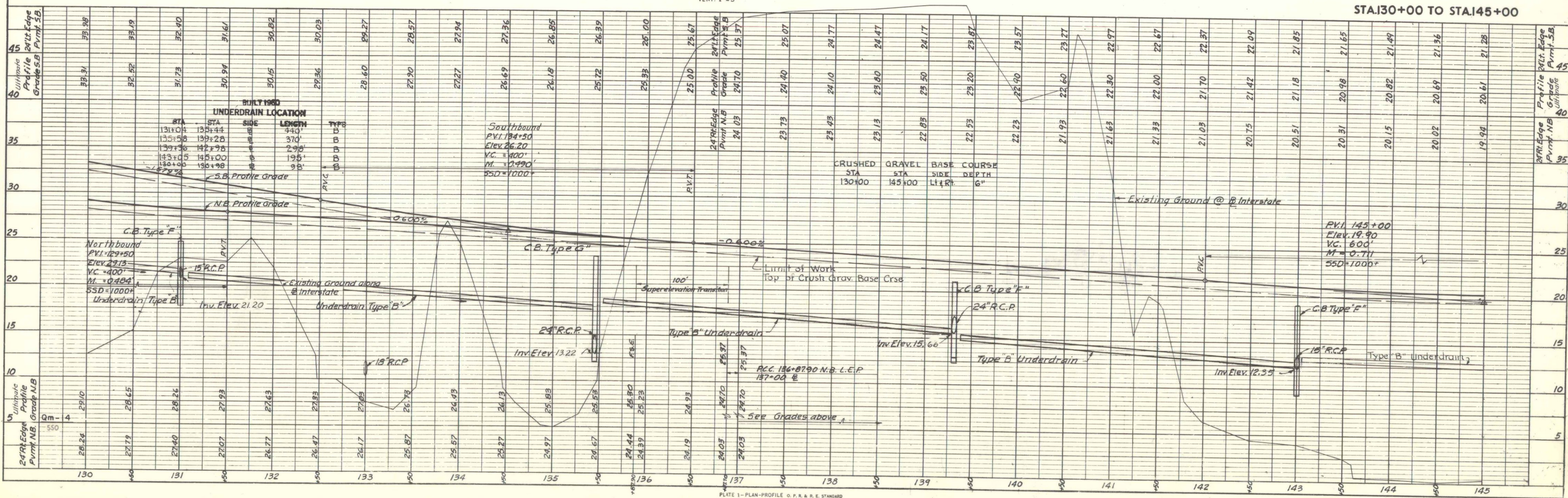
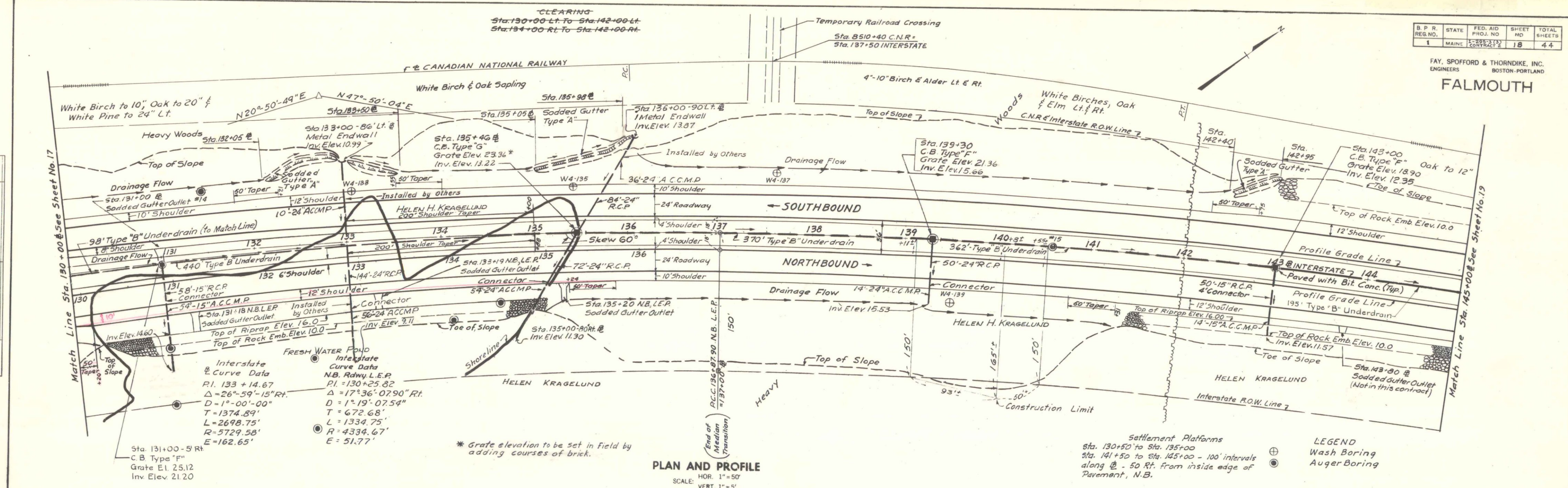



PLAN	DATE	BY	NO.
SURVEYED	9/17/58	F.S.	
NOTED			
BOOK			
AL			
NOTES			
RT. OF WAY			
CHECKED			
NO.			

PROFILE	DATE	BY	NO.
SURVEYED	9/17/58	F.S.	
NOTED			
BOOK			
AL			
NOTES			
STRUCTURE			
NOTATIONS			
CHECKED			
NO.			

